



felgains
inspiring care

Raizer Emergency Lifting Chair

A fast and safe solution when someone has fallen and needs help with transfer to either a standing or sitting position.

Why is the Raizer unique?

- Can be operated by one care giver
- Quick & easy assembly
- Extremely stable and fast lift action
- Can lift to a standing position
- Lightweight and easy to transport
- Exceptionally long battery life

To see the Raizer in action,
call us on 01473 741144
to arrange a demonstration.

Technical Information
SWL: 150kg/24 stone



1 Slide the seat under the person's knees.

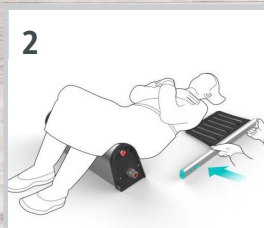

2 Carefully turn the person's shoulders and position the backrest.

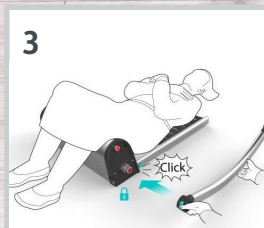

3 Push the rear leg onto the shaft and click into place.



4 Slide the front leg into place. Repeat steps 3 & 4 for the RH side.



5 Support the person's neck with one hand and raise the chair.

peace of mind

Felgains

33 Knightsdale Road
Ipswich Suffolk IP1 4JJ

T +44 (0) 1473 741144
F +44 (0) 1473 461933

mail@felgains.com
www.felgains.com